

Instruction Manual

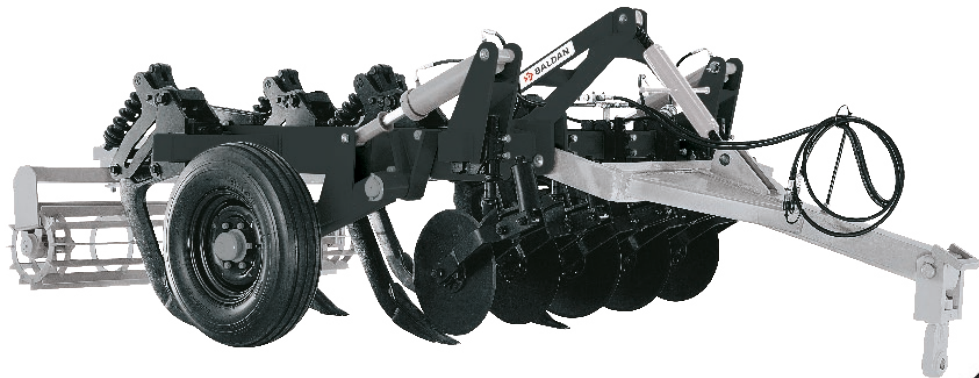

ASDA

Subsoiler Plow with Automatic Shank

> > BALDAN

INTRODUCTION

We thank you for the preference and congratulate your excellent choice in acquiring an implement of outstanding quality, manufactured in accordance with the advanced technology of **BALDAN IMPLEMENTOS AGRÍCOLAS S/A**.

This manual will assist you, in proceeds necessities, since when you bought until the operational proceeds application, security and maintenance.

The **BALDAN** guarantees that deliver this implement to the dealer, working properly, and in perfect conditions.

The dealers it's under the responsibility to keep the protection and conservation while keep the implement in your stock, and than, to assembly, tighten, lubrication and overhaul.

On time of the technical deliver, the dealer must to have conducted the user customer about the manutentation, safety, and your obligations in a possible technical assistance, the obligation to see the warranty terms and read the instruction manual. Any solicitation of warranty, please contact our Baldan technical service, by your Baldan dealer that you bought our implement. Reaffirm the necessity to read carefully of warranty certificate and note all of items from this manual, therefore you will increase the working life of your equipment.



Instruction Manual

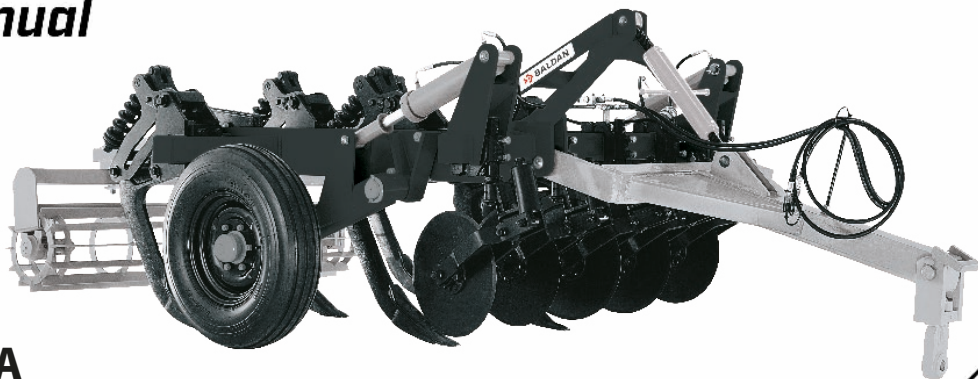

ASDA

Subsoiler Plow with Automatic Shank

BALDAN IMPLEMENTOS AGRÍCOLAS S/A.
CNPJ: 52.311.347/0009-06
Insc. Est.: 441.016.953.110



Scan the QR Code on the
identification plate of your
device and access this
Instruction Manual online.

> BALDAN

INDEX

01. Safety rules.....	4
02. Components	9 - 10
03. Technical specifications	11
04. Assembly	12 - 16
05. Hitching to the tractor.....	17
<i>Hitching ASDA-CR / ASDA-DR</i>	<i>17</i>
<i>Hitching ASDA-H.....</i>	<i>18</i>
<i>Centralization ASDA-H.....</i>	<i>19</i>
<i>Levelling of the subsoiler.....</i>	<i>20</i>
06. Adjustments and operations.....	21
<i>Depth adjustments asda-cr and asda-dr</i>	<i>21</i>
<i>Depth adjustment.....</i>	<i>22</i>
<i>Adjustment of the automatic tyne release</i>	<i>22</i>
<i>Cutter disc blade adjustments</i>	<i>23</i>
07. Operation	24
08. Preparing the subsoiler for transportation	25
09. Maintenance.....	26
<i>Lubrication.....</i>	<i>26</i>
<i>Bearings adjustments.....</i>	<i>29</i>
10. Cleaning.....	30
<i>Tire pressure</i>	<i>30</i>
11. Identification	31
<i>Note:</i>	<i>32</i>

01. SAFETY RULES



THIS ALERT SYMBOL INDICATES IMPORTANT SAFETY NOTES. WHENEVER YOU FIND IT IN THIS MANUAL, READ THE MESSAGE WITH ATTENTION TO AVOID ANY ACCIDENT.



WARNING

- *Read this instruction manual carefully to know the recommended safety rules.*

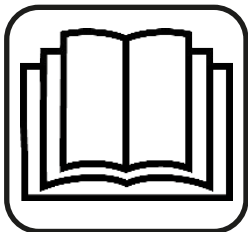

WARNING

- *Only start the tractor operations, when are you properly accommodated and with the seat belt fasted.*



WARNING

- *Never carry people over the tractor or equipment.*



BALDAN

Instruction Manual

01. SAFETY RULES



WARNING

- *There are risks of serious injury by tipping when working on slopes*
- *Never use excessive speed.*



WARNING

- *Before any equipment maintenance, make sure that is properly stopped*
- *Avoid getting hit*



WARNING

- *Do not work with the tractor if the front end is without enough weight to the rear equipment. There is tendency to lift, add weights at front or front wheels.*



ALCOHOL AND DRUGS MAY GENERATE LOSS OF REFLEX AND CHANGING OF OPERATOR FISICAL CONDITIONS. SO DO NOT WORK WITH THIS EQUIPMENT, IN USE OF THIS SUBSTANCE.



01. SAFETY RULES



WARNING

- The hydraulic system operate with a high pressure fluid, existing risk of serious injuries or death, search for damaged hose every day and replace it.
- Before coupling or uncouple the hoses relief the pressure, using the tractor's control when it is turned off.



WARNING

- Keep always away from the machine's active elements (discs), they are sharp and can cause accidents.
- When carrying out any service on the discs, use safety gloves on his hands.











BEBIDAS ALCOHOLICAS O ALGUNOS MEDICAMENTOS PUEDEN GENERAR LA PERDIDA DE REFLEJOS Y ALTERAR LAS CONDICIONES FÍSICAS DEL OPERADOR. POR ESTO, NUNCA TRABAJE CON ESTE EQUIPO, CASO ESTEA USANDOS ESTAS SUBSTANCIAS.













WARNING

The incorrect handling of the tractor engine can result in serious or fatal accidents. Before using the read carefully the instructions in this manual. Be sure that the person responsible for the operation is instructed about the correct handling and safety and has read and understood the instruction manual concerning this machine.

- 01-  When operating the implement do not allow people to stand close or on the implement.
- 02-  During assembly or disassembly of the discs section use protective gloves.
- 03-  When coupling or uncoupling the hydraulic hose relieve the hydraulic circuit pressure.
- 04-  Check out periodically the hoses condition. Where there is oil emptying change it immediately because the oil works under high pressure and may cause serious damage.
- 05-  Do not use large or daggy clothes because they can get caught on the implement.
- 06-  When you start the tractor engine, be correctly placed at the operator seat and be aware of the correct and safety handling of both tractor and implement. Always place the gearshift crank at the neutral position, turn off the gear of the power command and place the hydraulic commands at the neutral position.
- 07-  Do not turn on the tractor in a closed place without appropriate ventilation because the fumes from the fuel are is bad for health.
- 08-  While maneuvering the tractor to clamp the implement be sure that there is enough space and nobody is too close, maneuver always in slow gear and be ready to brake in case of emergency.

- 09-  Do not carry out adjustments with the implement working.
- 10-  When working over hilly areas try to keep the necessary stability. In case of instability reduce the acceleration, turn the wheels to the inclined side of the land and never lift the implement.
- 11-  Always use the tractor at safe speeds, especially when working in irregular or inclined areas, make sure the tractor is always in gear.
- 12-  When using the tractor on the road, keep the brake pedal connected.
- 13-  Do not work with the front tractor light. If there is a tendency to lift up add more weight in the front of the tractor at the front wheels.
- 14-  When leaving the tractor, place the gearshift at the neutral position and apply the park brake. Never let clamped implements be hitched to the tractor with the hydraulic system at the lifted position.
- 15-  Drugs and alcohol will affect an operator's alertness and coordination. Do not operate any engine under these conditions.
- 16-  Explain the operation, inspection and maintenance instructions to those users or operators who can not read.

ASDA - SUBSOILER PLOW WITH AUTOMATIC SHANK

02. COMPONENTS

- 01 - Hitch Shackle
- 02 - Hitch beam
- 03 - Hitch beam adjuster
- 04 - Discs
- 05 - Hydraulic piston
- 06 - Roller fixation support
- 07 - Roller oscilation bar
- 08 - Roller compression
- 09 - Roller bearing
- 10 - Rod with complete automatic disarming
- 11 - Wheel
- 12 - Wheel articulation support
- 13 - Central frame
- 14 - Hydraulic hoses
- 15 - Hydraulic hoses support

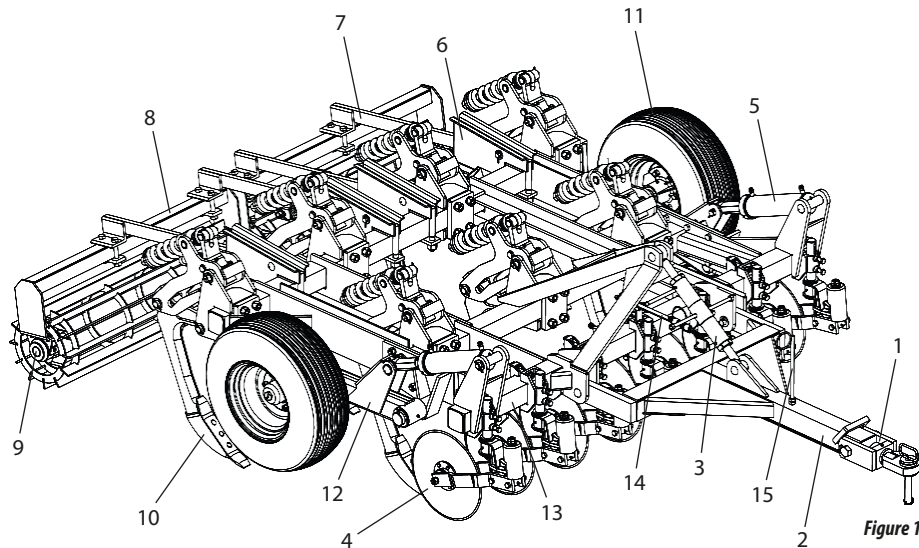

Figure 1

ASDA-CR - SUBSOILER PLOUGH, REMOTE CONTROL

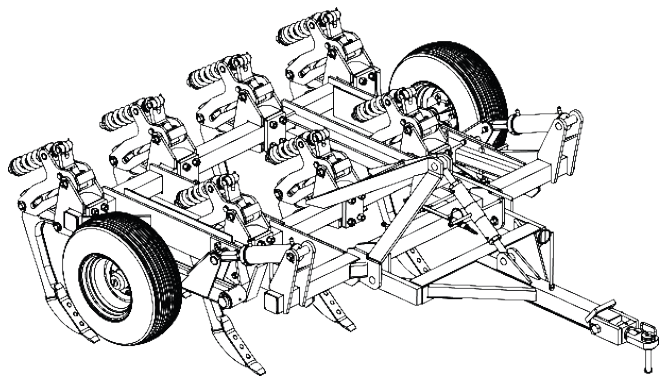

Figure 2

ASDA-H - MOUNTED SUBSOILER PLOUGH WITH AUTOMATIC SHANK

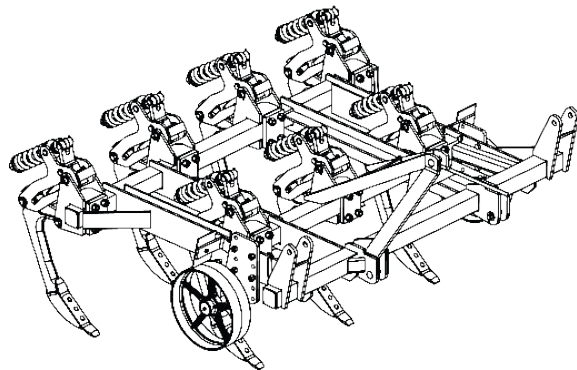

Figure 3

03. TECHNICAL SPECIFICATIONS

<i>Model</i>	<i>Nr of Tynes</i>	<i>Tynes Spacing (mm)</i>	<i>Nr. of Discs</i>	<i>Disc Diameter (ø)</i>	<i>Working Width (mm)</i>	<i>Depth (mm)</i>	<i>Approx. Weight (Kg)</i>	<i>Req. Tractor Power (HP)</i>
<i>ASDAH</i>	5	375	-	-	1875	450	1070	100 - 125
<i>ASDAH</i>	7	375	-	-	2625	450	1480	140 - 175
<i>ASDAH</i>	9	375	-	-	3375	450	1800	180 - 225
<i>ASDACR</i>	5	375	-	-	1875	450	1420	100 - 125
<i>ASDACR</i>	7	375	-	-	2625	450	1825	140 - 175
<i>ASDACR</i>	9	375	-	-	3375	450	1240	180 - 225
<i>ASDACR</i>	11	375	-	-	4125	450	2700	220 - 275
<i>ASDACR</i>	13	375	-	-	4875	450	3000	260 - 325
<i>ASDADR</i>	5	375	5	18"	1875	450	1850	100 - 125
<i>ASDADR</i>	7	375	7	18"	2625	450	2500	140 - 175
<i>ASDADR</i>	9	375	9	18"	3375	450	2900	180 - 225
<i>ASDADR</i>	11	375	11	18"	4125	450	3760	220 - 275
<i>ASDADR</i>	13	375	13	18"	4875	450	4200	260 - 325

ASDAH - Mounted subsoiler plough

ASDACR - Subsoiler plough, remote control

ASDADR - Subsoiler plough, remote control, with discs and roller

BALDAN reservase el derecho de cambiar las características técnicas de este producto sin previo aviso.

Las especificaciones técnicas són aproximadas y informadas en condiciones normales de trabajo.

04. ASSEMBLY

01 - Check if all the components are into the box.

02 - The safest and easier way to assemble the equipment is have wooden horses or similar supports available.

TYNE ASSEMBLY

03 - Notice the frame the marked spots where the tyne assembly will be attached on.

04 - Introduce the tyne assembly (1) onto the bar (2) put the bolts (3) and tighten with the washers and nuts (4).

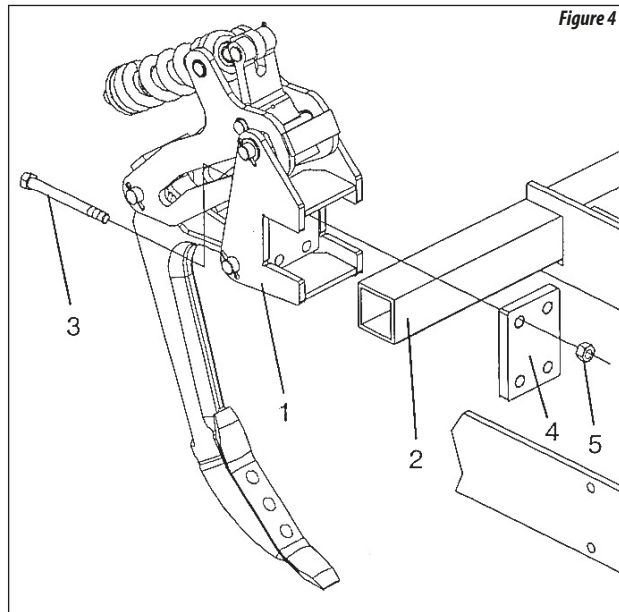

05 - The draws bellow show the right way to assembly and all available versions of subsoilers.

06 - Notice that all models have an odd number of tyne assemblies. Start mounting the center unit first and work your way out laterally. Observing the 375 mm spacing.

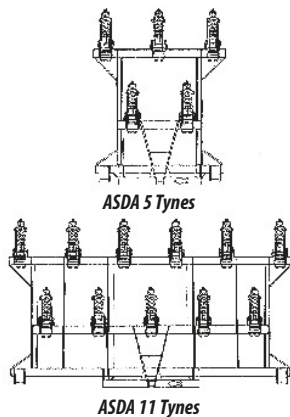

Figures 5

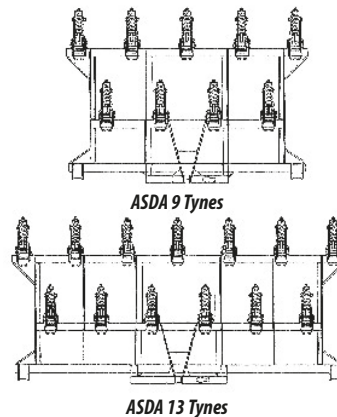
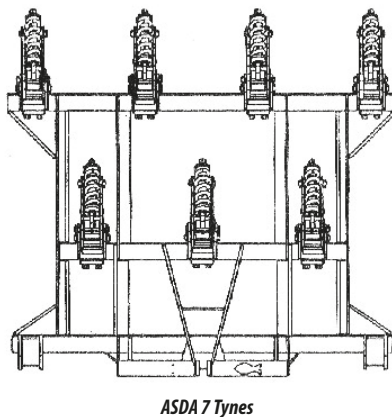

ASSEMBLING THE HITCH BEAM

- 07 - Place the coupling header (1) on the frame hitch (2) using the lock pins (3) washer and cotter pin (4), assemble the regulator (5) in the header, fixing it with the lock pin (6), washer and cotter pin (7) and in the frame with the lock pin (8) washer and cotter pin (9).

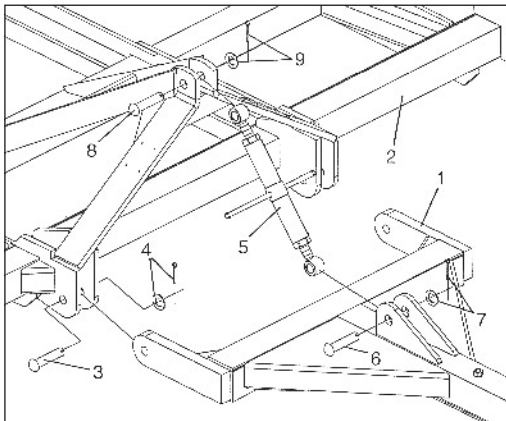

Figure 6

ASSEMBLING THE WHEEL

- 08 - Insert the piston (1) on the frame (2) with the lock pin (3) washer and cotter pin (4) and on the wheel support with the lock pin (5) washer and cotter pin (6).
- 09 - Mount the complete wheel (7) on the axle and fix with the nuts (8).

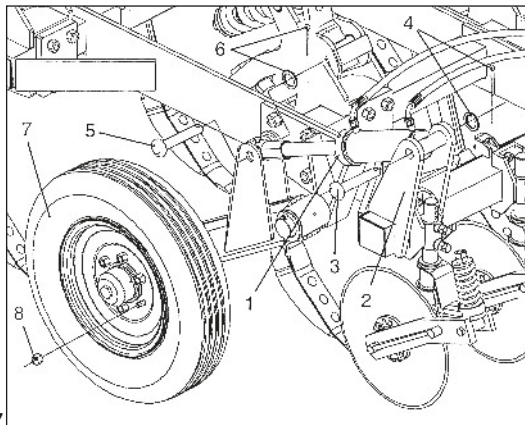

Figure 7

ASSEMBLING THE HYDRAULIC SYSTEM

- 10 - Couple the valve (1) to the support (2), connect the hoses (3) between the valve and the left piston (4), the hoses (5) on the right piston (6) and the hoses (7) for the remote control. **(Note the connection diagram next on figure 08). Do not reverse the hose connections. Make sure the hoses ends do not touch the ground).**

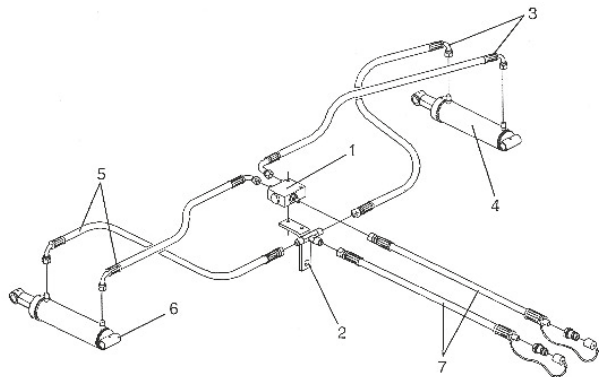

Figure 8

ASSEMBLING THE CUTTING DISCS

- 11 - Couple the complete cutting disc (1) to the frame (2) using the screws (3) braces (4) washer and nut (5).
- 12 - The cutting discs must be assembled in alignment with the rods.

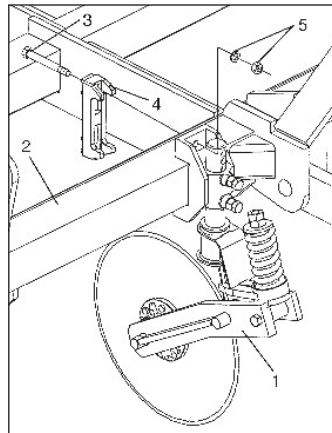
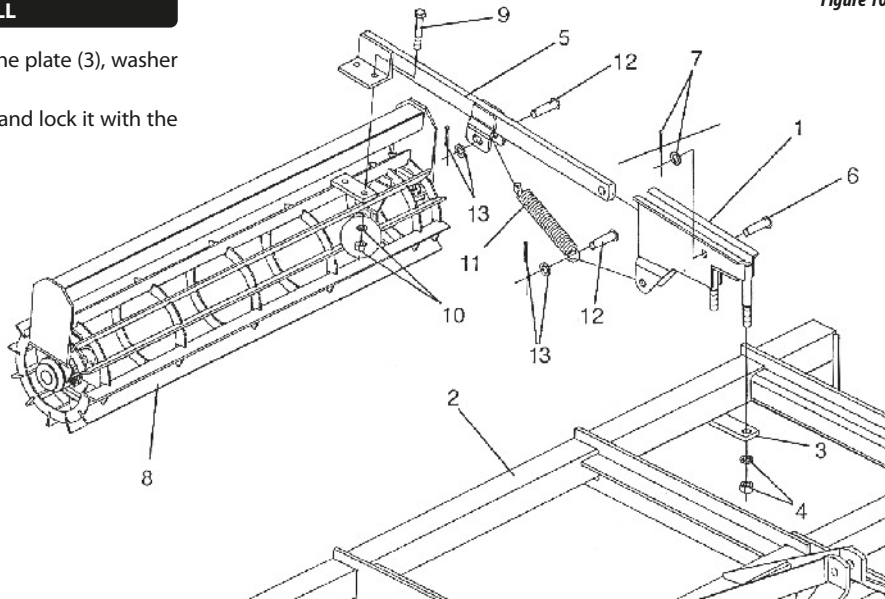

Figure 9

ASSEMBLING THE CRUSHING ROLL

Figure 10

- 13- Place the support (1) on the structure (2) with the plate (3), washer and nut (4).
- 14- Place the sway bar (5) between the support (1) and lock it with the pin (6), washer and lock (7).
- 15- Couple the crushing roll (8) to the sway bar (5) with the screw (9), washer and nut (10).
- 16- Then, place the spring (11) between the sway bar (5) and the support (1) using the pins (12), washers and locks (13).



05. HITCHING TO THE TRACTOR

- 01 - Before hith the subsoiler, make sure if the tractor is ready to operation:
- 02 - Make sure if the tractor has the front and wheel weights.
- 03 - Ballast the wheels according to the manufactures specifications.



Before turning on/off the hidraulic hoses, stop the tractor engine and release the pressure by the tractor commands. Beware for accidents with surround people when releasing the pressure with the equipment movement.

HITCHING ASDA-CR / ASDA-DR

- 04 - Adjust the height of the coupling header through the regulator (1). Couple the subsoiler to the tractor drawbar using the pin (2).
- 05 - To connect the hydraulic hoses (3) to connect the hydraulic hoses.

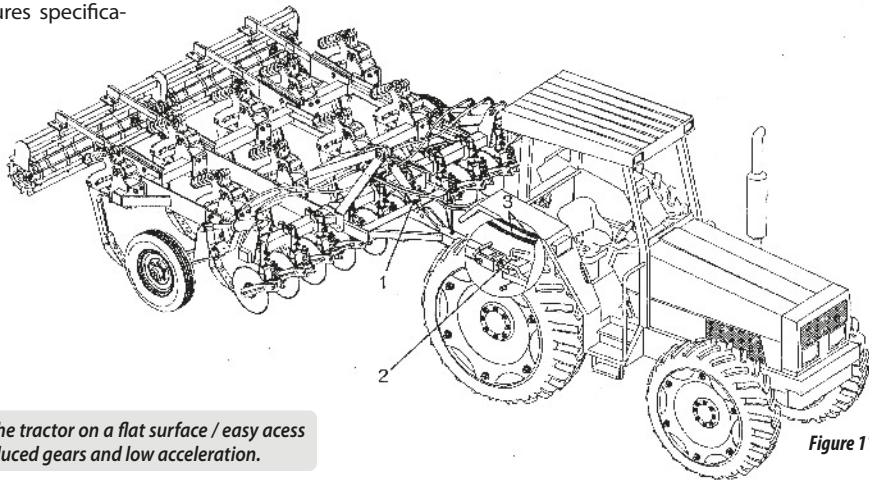

Figure 11



WARNING

Always hook up implements to the tractor on a flat surface / easy access and manouverability, use the reduced gears and low acceleration.

HITCHING ASDA-H

- 06 - To hitch the mounted model proceed the usual way using the 3 point hitch arms, first the bottom left, then the adjustable bottom right and at last the top link.
- 07 - Hitch the bottom left arm with the pin (1) figure 12 into the "A" support of the subsoiler.
- 08 - Hitch the 3rd point of the tractor into the "B" support of the subsoiler.
- 09 - Finally, using the "D" height regulator leveler, hitch the inferior right arm into the "C" support according to the figure.

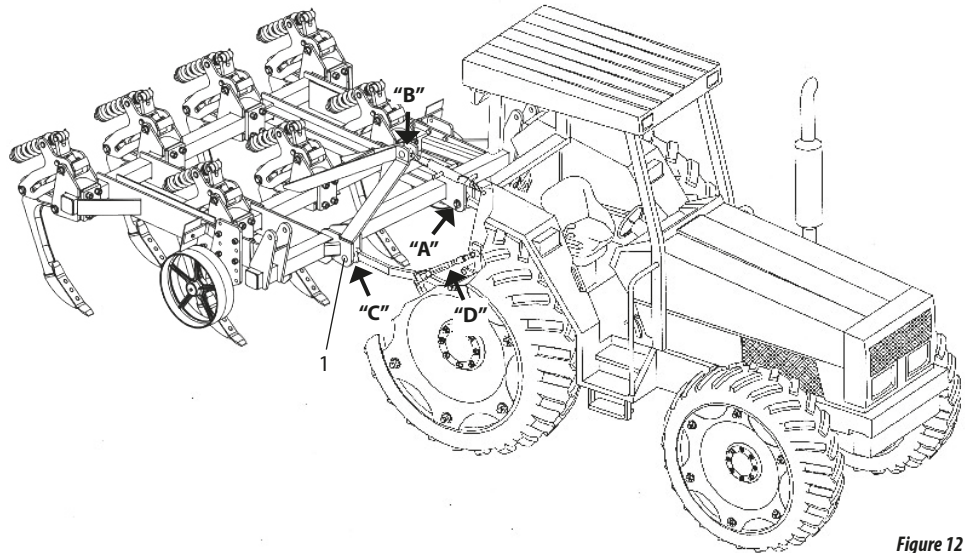

Figure 12

- 10 - The centralize the implement behind the tractor measure the distance between the bottom arms of the point hitch and the wheel. They must be adjusted to be the same. Both arms should be also at the same level between each other, figure 13.
- 11 - The top link will be now in line with the tractor center line.

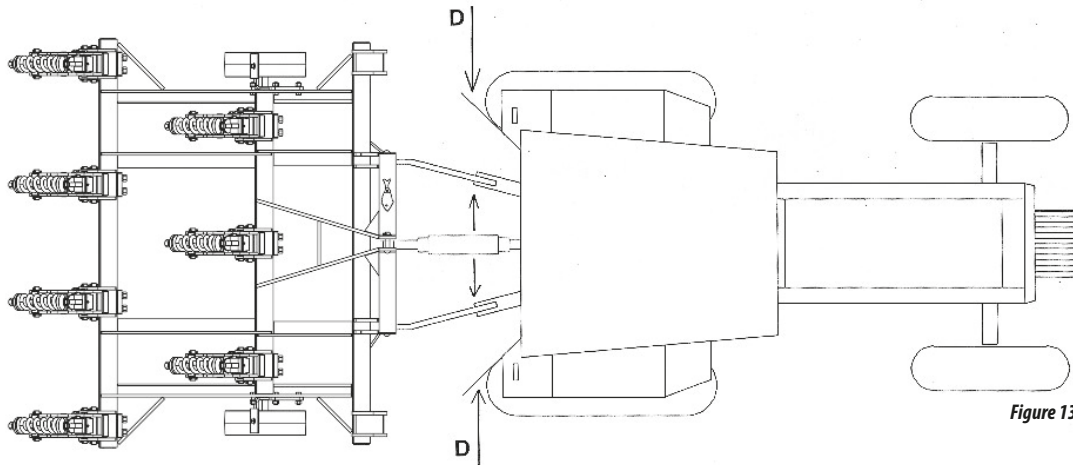

Figure 13

LEVELLING OF THE SUBSOILER

- 12-To level the equipment proceed as follow:
- 13-The tractor must be on a flat place and level the subsoiler in the transversal direction (width).
- 14-The longitudinal levelling (length) is done through the 3rd point arm.
- 15-Note that the rods should be parallel to the ground according to figure 14.

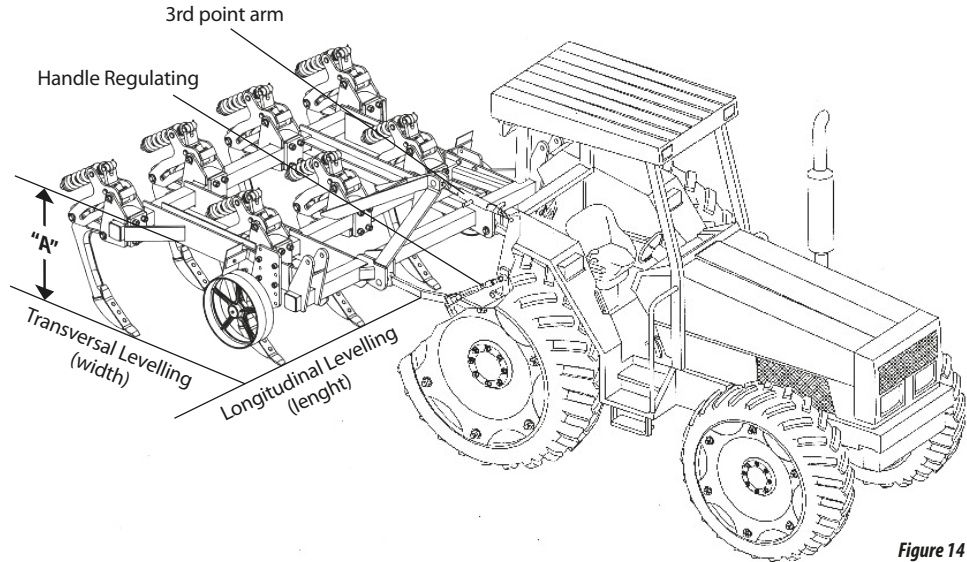

Figure 14

06. ADJUSTMENTS AND OPERATIONS

DEPTH ADJUSTMENTS ASDA-CR AND ASDA-DR

- 01 - The working depth of the strips is limited by the wheels (1) which are activated by the hydraulic cylinders (2).
- 02 - Determine the working depth of the strip, immediately lift the wheels via hydraulic cylinders up to the extent determined, place the rings limiters (3) in the cylinder rods.
- 03 - After adjustment, the depth is constant, because the rings are limiting the course of the cylinder, preventing the oscillation of the wheels, carrying on always the same depth.



WARNING

To place subsoiler transport barriers (4) on the stem of the cylinders and rings limiters (3).

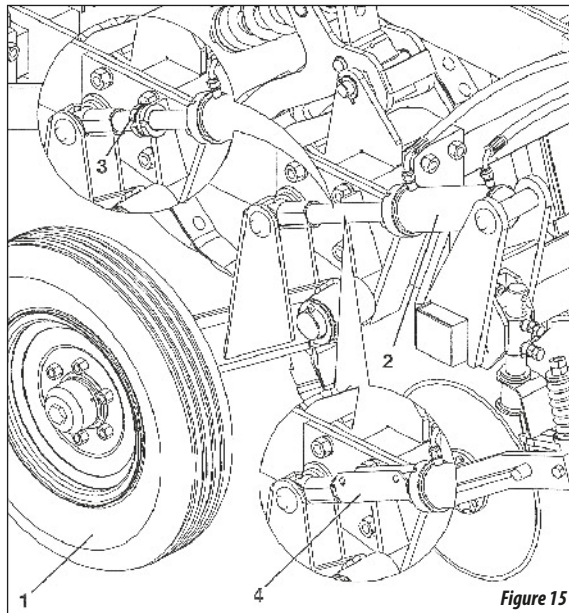
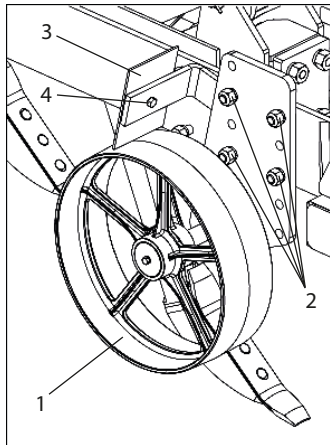

Figure 15

DEPTH ADJUSTMENT

- 04 - The depth control of the mounted ASDA-H is done by adjusting the wheels (1). To do this, loosen bolts (2) move the wheel up or down and fasten the bolts.



- 05 - At this time also adjust the wheel scraper (3) by loosening bolts (4), keep a free space between wheel and scraper of 10-20 mm and fasten the bolt (4).

- 06 - The automatic tyne disarming is shipped with determined resistance regulation, i.e. with 33.5 cm in width of the spring.



NOTE

For better use of a vibratory operation, operate with the lowest possible pressure, since in normal working conditions, do not disassemble the tyne.

Figure 16

ADJUSTMENT OF THE AUTOMATIC TYNE RELEASE

- 07 - To adjust the depth of the cutting blade (1), loosen the bolts (2) and scroll the shaft (3) to a desired regulation. Then tighten the screws



No need for regulations in other disarming system for the tynes. They begin disarming, check soil conditions, which must be very hard or high degree of compaction.

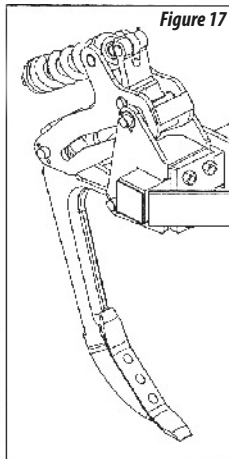
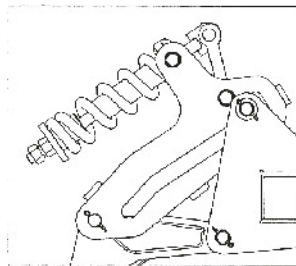

Figure 17

CUTTER DISC BLADE ADJUSTMENTS

(2).

08 - The spring (4) leaves the factory with calibrated pressure, no more pressure on it to neutralize no joint action cutting blades.



IMPORTANT

Note that the cutting blade should always be aligned with the tyne. The depth adjustment of the discs must be equal for all sets.

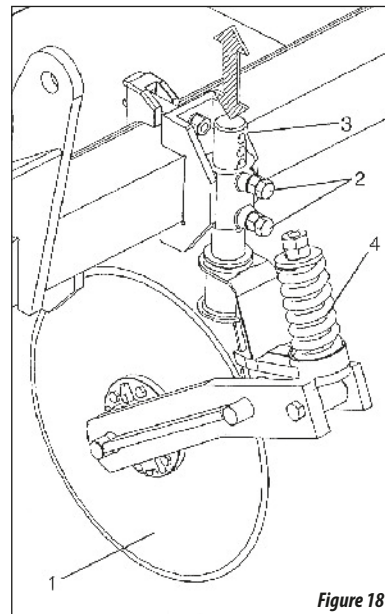

Figure 18



07. OPERATION

- 01 - The operation must be done subsolar relatively dry land, with the aim of breaking the litter (layer) compacted soil, generally known as double layer, topsoil or compacted layer only.
- 02 - Such guarantee this layer below the soil surface layer, ie, in approximately 10 to 15 cm deep, and has thickness variation of between 5 to 15 cm.
- 03 - Verify the depth of the compacted layer of soil through a penetrometer and appropriate regulation of the working depth of the tyne.
- 04 - The tynes have a unique security system auto disarmament, bumping into obstacles that come apart, and return to the normal operating position only lifting equipment.
- 05 - When operating with subsoiler, locate a gear that allows the tractor to maintain a certain reserve of power, ensuring against unforeseen efforts.
- 06 - The operating speed varies according to ground conditions, recommend an average of 4.5 to 5 km / hour.

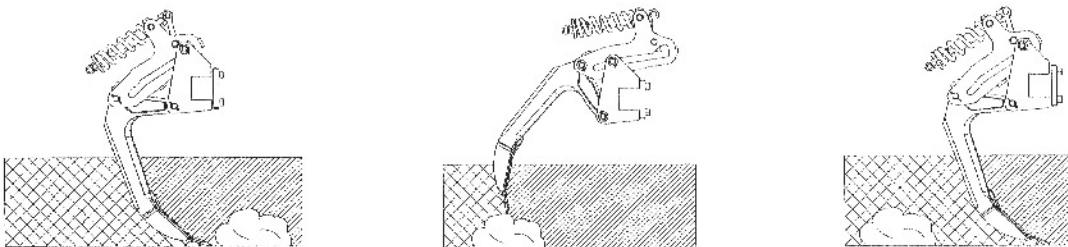

Figure 19

08. PREPARING THE SUBSOILER FOR TRANSPORTATION

01 - Before transporting the subsoiler, must prepare as follows:

02 - Remove the bolt (1), washer (2) setting in the spring (3) swing bar (4), leaving open the spring, under "Detail A".

03 - Then move the clod roller (5) in the up position so that the roller is on the subsoiler, "Detail B".

Figure 20



If there is a need to raise a roller, use proper equipment.



Before performing the operation lift the roller, release the springs between the bars and swing support rods, as shown in figure 20.

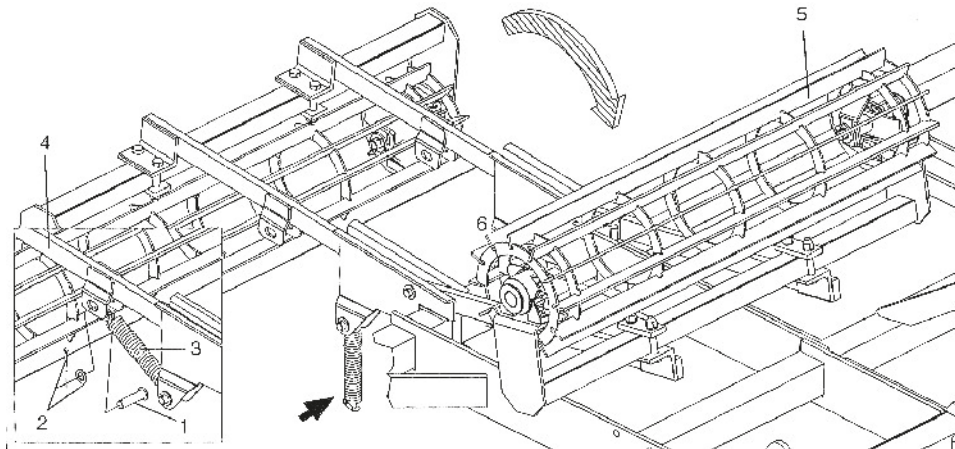

09. MAINTENANCE

- 01 - Check daily the fixation of bolts, nuts and pins.
- 02 - The tyre points are reversible, observe periodically the wear-out points when necessary.
- 03 - Check the cutting edge of the discs.

LUBRICATION

- 04 - Lubrication is essential for good performance and durability of moving parts of the sub-soiler saving maintenance costs.
- 05 - Before starting work, carefully lubricate all grease fittings, observing the lubrication intervals, ensuring the quality of the lubricant, efficiency and purity, avoiding using products contaminated by water, dirt, etc..
- 06 - Before starting lubrication, clean all grease fittings with a clean, lint-free cloth and replace any that are damaged.

TABLE OF EQUIVALENT AND GREASES

<i>Manufacturer</i>	<i>Grease Type</i>
<i>Petrobrás</i>	<i>Lubrax GMA 2</i>
<i>Atlantic</i>	<i>Litholine MP 2</i>
<i>Ipiranga</i>	<i>Super Grasa Ipiranga Ipiranga Super Grasa 2 Ipiflex 2</i>
<i>Castrol</i>	<i>LM 2</i>
<i>Mobil</i>	<i>Mobilgrease MP 77</i>
<i>Texaco</i>	<i>Marfak 2 Agrotex 2</i>
<i>Shell</i>	<i>Retinax A Alvania EP 2</i>
<i>Esso</i>	<i>Multipurpose grease H</i>
<i>Bardahl</i>	<i>Maxlub APG 2 EP</i>

Table 3



If there were other manufacturers or and other. Equivalent trends that are not listed in this. Table, consult the manufacturer's technical manual.

Lubricate every 10 hours

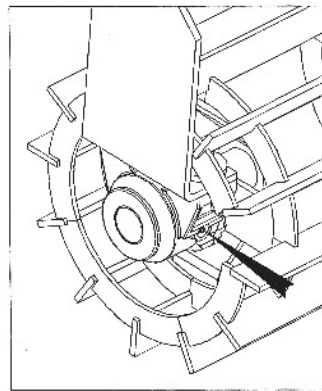
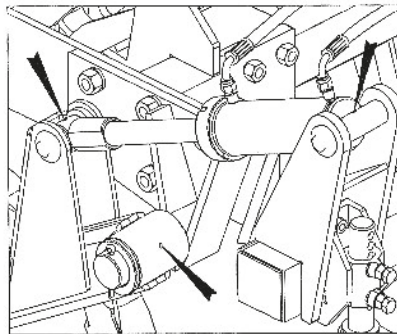
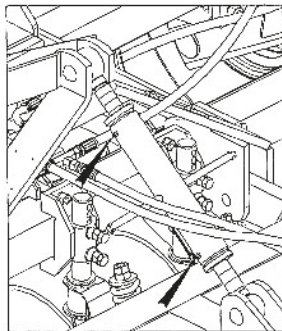
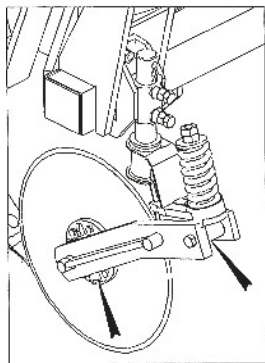
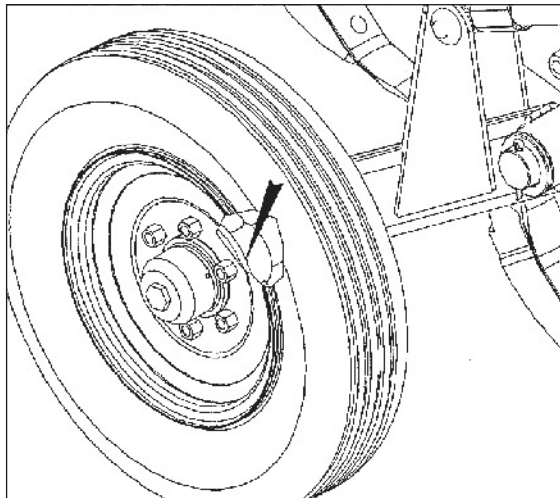
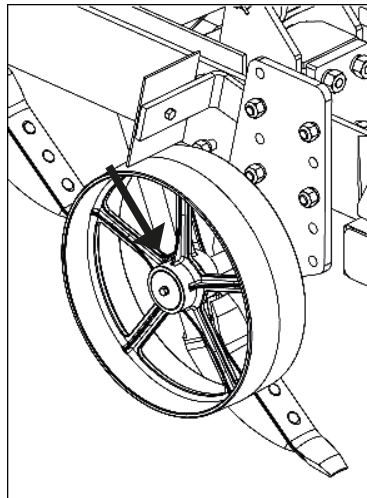

Figure 21

Lubricate every 60 hours



Lubricate every 100 hours



Figures 22

BEARINGS ADJUSTMENTS

- When the bearings submit clearances, adjust them as follows:

07 - Loosen the screws (1);

08 - Remove the joint (3), the bearing cover and replace it again.

09 - If the gap persists, it can be facemills the cover (2) to increase the tuning then mount the same on the bearing with many joints as required.

10 - The bearing must rotate freely, ie without axial or radial clearances.

11 - Grease the bearing again. The amount of grease used is 150 grams.

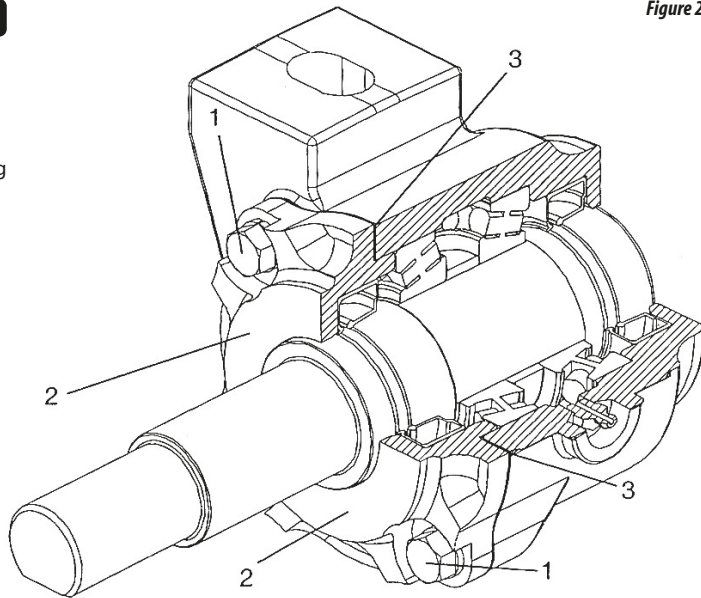

Figure 23

TIRE PRESSURE

- 12 - Tires should always be properly calibrated avoiding premature wear due to excess or lack of pressure.
- 13 - A tire pressure 7.50 x 16 should be (55lb/pol2) and 900 x 16 tires must be (60lb/pol2) for each.

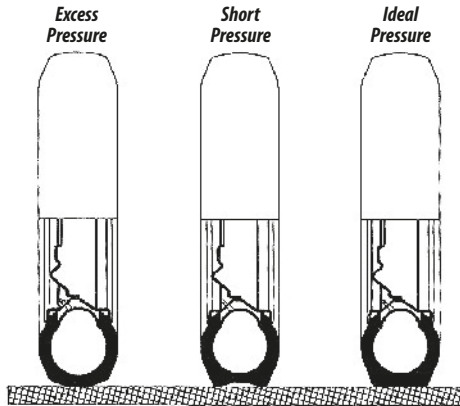

Figure 24

10. CLEANING

- 01 - When assembling or disassembling any portion of the subsoiler, use proper tools.
- 02 - Check all moving parts of the subsoiler, present themselves wear or looseness, make the necessary adjustment or replacement of parts, leaving the equipment ready for the next use. Use original parts Baldan.
- 03 - Make a clean sweep in the subsoiler, check where the paint is worn, a full coat.
- 04 - Lubricate the machine completely.
- 05 - When the implement is not going to be used for a longer period we recommend to store it in good conditions for conservation. Clean and grease, patch up paint, spray oil over the implement and points before storage.

11. IDENTIFICATION

01 - In order to refer parts catalogues or apply technical support from Baldan, always indicate model (1), serial number (2), manufacture date (3) located on the identification tag.

ALWAYS REQUIRE BALDAN ORIGINAL PARTS

		
BALDAN IMPLEMENTOS AGRÍCOLAS S/A. AV. BALDAN, 1500 NOVA MATÃO CEP 15.993-900 MATÃO-SP BRASIL FONE: (16) 3221-6500 CNPJ: 52.311.347/0009-06 CREA/SP 0170977		
01 — Modelo / Model	03 — Data / Date	
02 — N° de Série / Serial Number	Tipo / Type	
Capacidade / Load Capacity	Peso / Weight	



PUBLICATIONS

Code: 6055010081-1
CPT: ASDA01618



WARNING

The draws contained in this instruction manual are merely illustrative.



CONTACT

*In case of doubt do not operate the equipment, please contact our After-sales Service.
Phone: 0800-152577
e-mail: export@baldan.com.br*

PRODUCT IDENTIFICATION

- Do the identification below to always have the properly informations about your equipment life time.

Owner: _____

Dealer: _____

Farm: _____

City: _____ *Country:* _____

Model: _____

Warranty certified number: _____ *Serial number:* _____

Purchase date: ____/____/____ *Invoice. Nr:* _____

This image shows a blank sheet of white paper with horizontal ruling lines. The lines are evenly spaced and extend across the width of the page. There are no margins, text, or other markings on the paper.

CERTIFICATE OF WARRANTY

- 01 - **BALDAN IMPLEMENTOS AGRÍCOLAS S/A**, guarantee the normal operation of the product for a 6 (six) months period dated from the dealers's bill of sale to the first final customer.
- 02 - During this period, **Baldan** compromise itself to repair the material or manufacturing defects, but the labour, the freight and other expenses are the dealer's responsibility.
- 03 - At the guarantee period, all the request and replacement of any defective part must be made to the dealer of the region, which will send the defective part for analysis at **Baldan**.
- 04 - When this procedure won't be possible and the dealer couldn't have the ability to solve the problem, the dealer can ask for **Baldan's Technical Assistance** using the specific form delivered to them.
- 05 - After the analysis of the items replaced by **Baldan Technical Assistance** and if we conclude that it wasn't a guarantee problem, then the dealer will be the responsible for all costs related to the replacement; as well as material expenses, travel including accommodation and meals, also the accessories, lubricant used or any other expenses after having called the Technical Assistance. And, withal, the company Baldan is authorized to issue the billing in name of the respective reseller.
- 06 - Any repair made to the product which is in warranty period by the dealer, will only be authorized by Baldan after budget previous presentation describing pieces and labour to be accomplished.
- 07 - It is out of this term the product which has repairs or modifications not made by dealers from Baldan's network, as well as pieces applications or not authentic components to the product by the user.
- 08 - This certificate of guarantee will become invalid when notice that the damage or defect is the result of incorrect use of the product, of instructions non-observance or operator's inexperience.

- 09 - It's stipulated that this guarantee don't cover tires, polyethylene deposits, universal joints, hydraulic components, etc, wich equipments are guarantee by their manufacturers.
- 10 - The material or manufacture defects, object of this certificate of guarantee, will not be, by any hypotesis, reason for cancellation of the contract of sale, or indemnity of any kind.
- 11 - For a warranty solicitation to the distributor, you have to proceed in the following manner:
- 12 - Send the technical informe detailed telling the problem (technical assistance request form to the client), you can find it send us an email to **after-sales@baldan.com.br** or acessing our website.
- 13 - If it's possible send films and photos from the requested spare parts.
- 14 - To point at the form: serial number, manufacture year, etc, that is, all information asked at the form. The damage spare parts should be available for analysis of the the after sales department in a future visit (in case of requested).
- 15 - **Baldan** keeps the right of changing and or improve the technical characteristics of its products, without notice and without the obligation of act like this way with its previously manufactured products.

INSPECTION AND DELIVERY CERTIFICATE

- **SERVICE BEFORE THE DELIVERY:** This equipment was very carefully prepared by the dealer's organization, inspected in all its parts in agreement with the manufacture's prescription.
- **DELIVERY SERVICE:** The user was informed about the current guarantee terms and instructed about maintenance care and utilization.
- I confirm that I was informed about the current guarantee terms and instructed about the correct utilization and maintenance of this product.

Product: _____ *Serial number:* _____

Date: _____ *Bill of sale:* _____ *Store:* _____

City: _____ *State:* _____ *Zip code:* _____

Owner: _____ *Phone:* _____

Adress: _____ *Number:* _____

City: _____ *State:* _____

E-mail: _____ *Date of sale:* _____

INSPECTION AND DELIVERY CERTIFICATE

- **SERVICE BEFORE THE DELIVERY:** This equipment was very carefully prepared by the dealer's organization, inspected in all its parts in agreement with the manufacture's prescription.
- **DELIVERY SERVICE:** The user was informed about the current guarantee terms and instructed about maintenance care and utilization.
- I confirm that I was informed about the current guarantee terms and instructed about the correct utilization and maintenance of this product.

Product: _____ *Serial number:* _____

Date: _____ *Bill of sale:* _____ *Store:* _____

City: _____ *State:* _____ *Zip code:* _____

Owner: _____ *Phone:* _____

Adress: _____ *Number:* _____

City: _____ *State:* _____

E-mail: _____ *Date of sale:* _____

INSPECTION AND DELIVERY CERTIFICATE

- **SERVICE BEFORE THE DELIVERY:** This equipment was very carefully prepared by the dealer's organization, inspected in all its parts in agreement with the manufacture's prescription.
- **DELIVERY SERVICE:** The user was informed about the current guarantee terms and instructed about maintenance care and utilization.
- I confirm that I was informed about the current guarantee terms and instructed about the correct utilization and maintenance of this product.

Product: _____ Serial number: _____

Date: _____ Bill of sale: _____ Store: _____

City: _____ State: _____ Zip code: _____

Owner: _____ Phone: _____

Address: _____ Number: _____

City: _____ State: _____

E-mail: _____ Date of sale: _____

3ª Page - Manufacturer

Please send this filled copy to Baldan, until 15 days after the purchase.

Signature / Store's stamp _____

1.74.05.0059-5

AC MATÃO
ECT/DR/SP

RESPONSE CARD

NO STAMPING IS REQUIRED

THE STAMP WILL BE PAID BY:



BALDAN

BALDAN IMPLEMENTOS AGRÍCOLAS S/A.

Av. Baldan, 1500 | Nova Matão | CEP: 15993-500 | Matão-SP | Brasil

Fone: (0**16) 3221-6500 | Fax: (0**16) 3382-6500

Home Page: www.baldan.com.br | e-mail: sac@baldan.com.br

Exportação: Phone: 55 16 3321-6500 | Fax: 55 16 3382-4212 | 3382-2480

e-mail: export@baldan.com.br



Avenida Baldan, 1500
Nova Matão
15.993-900
Matão/SP - Brasil
sac@baldan.com.br
export@baldan.com.br

+55 16 3221 6500
baldan.com.br